

We offer 11 unique floor plan arrangements - rest assured there's one perfect for you

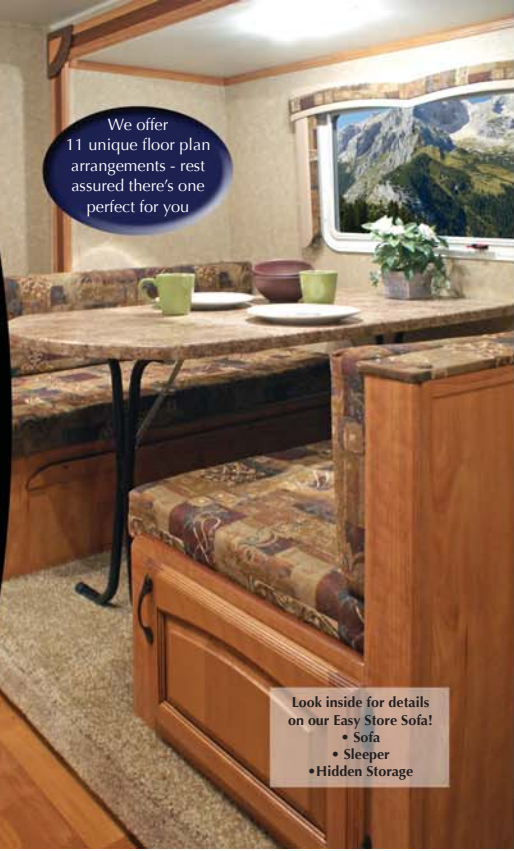

Look inside for details on our Easy Store Sofa!

- Sofa
- Sleeper
- Hidden Storage

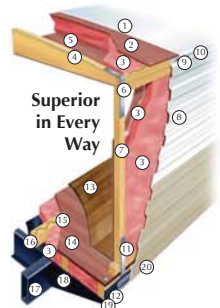

Superior in Every Way

1. One-piece, seamless roof with 12 year warranty
2. Strong wood roof decking, glued and screwed
3. Thick blanket of hand-cut fiberglass insulation for long lasting energy efficiency. Glued to bond to sidewalls to prevent slipping
4. Solid roof rafter
5. Interior ceiling board
6. Galvanized steel straps - used to increase the roof-to-sidewall strength
7. Sturdy wood sidewall construction, 16" on centers (Walls are always set on the floor, not next to it, for maximum strength -and screwed into place)
8. Exterior aluminum siding with baked enamel finish
9. Butyl caulking for superior seal and less black streaks
10. Drip rail/awning rail, screwed to roof framing helps keep unit clean
11. Galvanized steel straps used to increase the sidewall-to-floor transition strength and solidify our unibody construction
12. Tough poly max underbelly wrapped up sides and end protects against moisture and debris
13. Durable heavy gauge linoleum floor covering
14. 5/8" floor decking glued and screwed to floor joists (NA 15" and 17")
15. Thick blanket of fiberglass insulation
16. Sturdy wood floor joist system, 13" or less O.C.
17. Tubular steel frame
18. Full width steel outriggers - superior strength & support
19. Steel bolts to secure floor to steel outriggers
20. Heavy gauge radius lower model

Post Office Box 1005 Nappanee, IN 46550  
 • Your Gulf Stream Coach Dealer •

GULF STREAM COACH, INC.



Quality, Value & Innovation Since 1983  
 Gulf Stream Coach is a privately owned company with over 26 years of RV manufacturing experience.

RV dealers and consumers look to Gulf Stream for high-value products offering quality construction, innovative features, contemporary design, unmatched service, and continual support.

Gulf Stream offers the largest product line in the industry. From entry level travel trailers to luxury motorhomes - all use the most advanced manufacturing techniques.  
[www.GulfStreamcoach.com](http://www.GulfStreamcoach.com)



Ameri Lite Ultra-Lite BY GULF STREAM

**24 Month Warranty on Structural Components\***

In addition to our standard one year warranty, Gulf Stream Coach, Inc. offers an exclusive 24 month warranty on structural components. In addition, major component manufacturers are providing 24 month warranties on their products installed in Gulf Stream units such as refrigerator, antenna, furnace, water heater, air conditioner, awning, range, microwave and more. See official written Gulf Stream warranty for complete details and restrictions.

For more information and available options, contact your local Gulf Stream Dealer: [www.GulfStreamCoach.com](http://www.GulfStreamCoach.com), or Gulf Stream Coach, Inc. Gulf Stream reserves the right to make changes in prices, colors, materials, components, and specifications, and to discontinue models at any time without notice or obligation. Assumes no responsibility for any error in type or print reproduction of specifications or floor plans in this brochure. Photos may show equipment or items that are optional and are not included in the price of the trailer. Experience and review a current model at your nearest dealer. ©2010 Gulf Stream Coach, Inc. Nappanee, Indiana U.S.A.

Ameri Lite Ultra-Lite GULF STREAM COACH, INC.

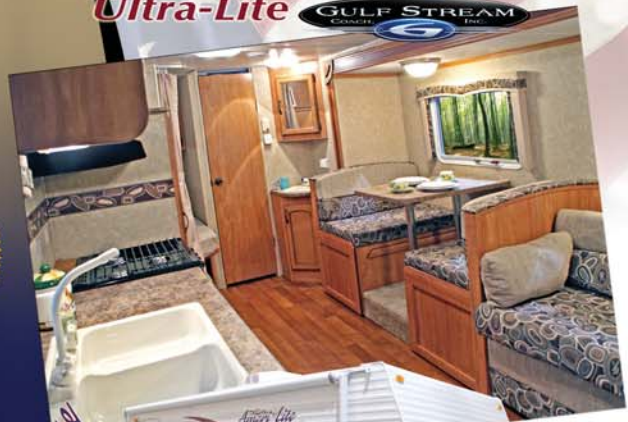

Quality, Value & Innovation Since 1983

# Ameri Lite

## Ultra-Lite

Rediscover America!  
It's spacious, open and  
the views are spectacular.

For that home away from home feel, nothing beats the Ameri Lite for spaciousness and livability! Choose the floor plan that fits your family's needs, pick your favorite decor from

the professionally designed interior decor packages, and start enjoying quality time with your family in tow - only in the Ameri Lite by Gulf Stream.

*At Gulf Stream we know the importance of feeling comfortable in the kitchen. Meals will be a pleasure to prepare in the Ameri Lite's efficiently designed kitchen space.*

### Some of the Many Standards

- One piece roof (12 year warranty)
- Abundant outside storage
- Electric brakes
- Furnace with electric ignition
- Tubular steel, Cambered frame
- Floor joists - 13" on center
- Floor decking screwed and glued
- Wall studs every 16" or less on center
- Radius entry door
- Roller bearing drawer guides
- Hardwood drawer fronts
- Vinyl lined drawers
- Tapered roof rafters
- Fiberglass insulation - hand cut and glued
- 6 gallon gas water heater
- Hardwood mortise and tenon cabinet doors
- Mini blinds throughout
- 3-burner range top
- Flush mount refrigerator
- Easy store sofa/bed (most models)
- System monitor panel
- Designer window treatments
- Bed lifts for easy access
- 45 amp power converter

### LE Package

- Roof air conditioner
- Roll out awning
- Microwave oven
- TV antenna
- Stabilizer jacks

### Platinum Package

- AM/FM CD/DVD Touchplex stereo theatre
- 3 burner cooktop with oven
- Outside shower
- Extra cabinet overhead
- Upgraded TV antenna

### Floor Plans & Specifications



**MODEL 15 FD**  
Length 17'2"  
Width 90"  
Height w/AC 114"  
Interior Height 6'4"

Carrying Capacity 1,572  
Hitch Weight 360  
Dry Weight 2,288  
Fresh Water 30  
Waste Water Tank 54



**MODEL 15 BH**  
Length 17'2"  
Width 90"  
Height w/AC 114"  
Interior Height 6'4"

Carrying Capacity 1,232  
Hitch Weight 230  
Dry Weight 2,496  
Fresh Water 30  
Waste Water Tank 54



**MODEL 19 KD**  
Length 21'8"  
Width 90"  
Height w/AC 116"  
Interior Height 6'4"

Carrying Capacity 3,632  
Hitch Weight 360  
Dry Weight 3,728  
Fresh Water 30  
Waste Water Tank 54



**MODEL 21 MB**  
Length 22'7"  
Width 90"  
Height w/AC 114"  
Interior Height 6'4"

Carrying Capacity 1,125  
Hitch Weight 340  
Dry Weight 3,215  
Fresh Water 30  
Waste Water Tank 54



**MODEL 22 RS**  
Length 24'4"  
Width 90"  
Height w/AC 116"  
Interior Height 6'4"

Carrying Capacity 3,602  
Hitch Weight 600  
Dry Weight 3,998  
Fresh Water 30  
Waste Water Tank 54



**MODEL 23 BW**  
Length 26'2"  
Width 90"  
Height w/AC 114"  
Interior Height 6'4"

Carrying Capacity 2,742  
Hitch Weight 670  
Dry Weight 3,928  
Fresh Water 30  
Waste Water Tank 54



**MODEL 24 BH**  
Length 25'1"  
Width 90"  
Height w/AC 114"  
Interior Height 6'4"

Carrying Capacity 2,295  
Hitch Weight 430  
Dry Weight 3,625  
Fresh Water 30  
Waste Water Tank 54



**MODEL 24 RK**  
Length 27'5"  
Width 90"  
Height w/AC 116"  
Interior Height 6'4"

Carrying Capacity 2,949  
Hitch Weight 490  
Dry Weight 4,241  
Fresh Water 30  
Waste Water Tank 54



**MODEL 25 BH**  
Length 27'5"  
Width 90"  
Height w/AC 116"  
Interior Height 6'4"

Carrying Capacity 3,500  
Hitch Weight 440  
Dry Weight 3,940  
Fresh Water 30  
Waste Water Tank 54



**MODEL 255 BH**  
Length 28'10"  
Width 90"  
Height w/AC 116"  
Interior Height 6'4"

Carrying Capacity 2,740  
Hitch Weight 620  
Dry Weight 4,880  
Fresh Water 30  
Waste Water Tank 54



**MODEL 27 BH**  
Length 29'11"  
Width 90"  
Height w/AC 116"  
Interior Height 6'4"

Carrying Capacity 2,759  
Hitch Weight 660  
Dry Weight 4,901  
Fresh Water 30  
Waste Water Tank 54

All weights shown are in dry conditions, without options or loads. Please refer to additional options and features. Consult the weight tag inside kitchen cabinet and your tow vehicle owners manual for more information.

### Interior Decor



Plenty of counter space, storage & conveniences!



3 in 1 feature • from sofa to sleeper to extra hidden storage



Crank out windows keep you dry while circulating fresh air



Lined drawers with roller bearing guides for ease and cleanliness